

GOODYEAR[®]
AVIATION



INNOVATION

AT THE SPEED OF LIGHT

The **NEW** Goodyear Flight Radial[®] Tire for Boeing 737 MAX:
As we get lighter, you soar higher.

EVERY LANDING COUNTS.™ ESPECIALLY WHEN EVERY LANDING BENEFITS FROM GOODYEAR'S NEW ADVANCED TECHNOLOGY.

The NEW Goodyear Flight Radial® Main Tire for Boeing 737 MAX is lighter AND stronger:

MORE weight savings for MORE efficiency

- » Nearly 160 lbs. lighter per shipset versus our conventional bias tire technology*

MORE strength for MORE landings

- » More than 25% increased landings over our conventional bias tire technology**
- » More landings can help you:
 - reduce tire consumption
 - lower inventory levels
 - lower maintenance and overhaul costs

MORE innovation for MORE performance

- » Goodyear exclusive Featherweight Aluminum Core Bead Technology
 - reduces tire weight to ultra-light status
- » Goodyear Flight Radial® with Fortified Merged Cord Technology
 - DuPont™ Kevlar® wound with nylon, combines to enhance strength and reduce weight
 - decreases casing growth for enhanced resistance to foreign object damage
 - offers excellent wear resistance for long tread life
 - requires fewer wheel changes, lowering maintenance costs
- » Goodyear DiamondWeave Belt Technology
 - specialized cord placement for optimized treadwear

FLIGHT RADIAL®

TIRE SIZE	USAGE	PR	SPEED	DESCRIPTION	PART NO.	BOEING PART NO.	AIRCRAFT†
H44.5X16.5R21	Main	30	235 mph	Flight Radial	441Q09-1	S294W502-253‡	737 MAX 7/8 or 737 Next Generation 600/700/800/900/900ER
27X7.75R15	Nose	12	225 mph	Flight Radial	275Q22-1	S294W502-182	737 Next Generation 600/700/800/900/900ER
27X7.75R15	Nose	12	235 mph	Flight Radial	275Q29-1	S294W502-183	737 MAX 7/8 or 737 Next Generation 600/700/800/900/900ER

*Compared to a Goodyear bias 30PR, 48,400 rated load; 230 psi rated pressure; 235 mph rated speed tire.

**Projected annual average based on commercial airline fleet focus testing of H44.5x16.5R21 30PR for Goodyear Flight Radial®, as compared to annual average of same size Goodyear bias tire.

†Reference Boeing Service Letters (737-SL-32-079 and 737-SL-32-101) for tire/wheel/aircraft approved configurations.

‡Not approved for installation with wheel P/N C20626200 manufactured by Safran Landing System.

DuPont™ and Kevlar® are trademarks or registered trademarks of E.I. du Pont de Nemours and Company used under license by The Goodyear Tire & Rubber Company and affiliates.

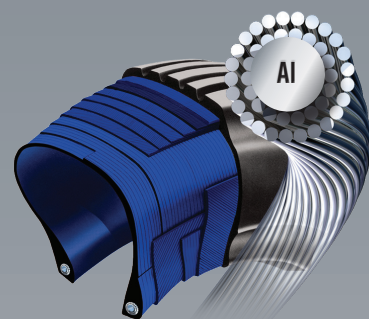

FEATHERWEIGHT ALUMINUM
CORE BEAD TECHNOLOGY



FORTIFIED MERGED CORD TECHNOLOGY

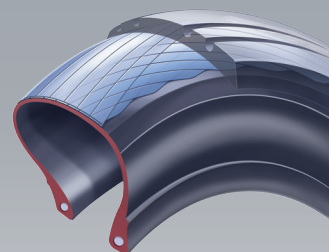

DIAMONDWEAVE BELT TECHNOLOGY



GOODYEAR®
A V I A T I O N
GOODYEARAVIATION.COM